

Coach Post Top Light



-Overview:

This post top street light is a high-tech twist on an everyday fixture. Type V optics (Type III optional) produce a round distribution which is perfect for parking lots and pathways. Cutting edge LED technology provides maintenance-free operation combined with significant reduction in energy consumption. Add all that to a standard tenon top pole and you've got a simple and effective lighting solution.

- Application

With IES classification Type V (Type III optional), this led area light distributes light in a wide and uniform 360° pattern that is perfect for large outdoor areas such as parking lots, corporate parks, and retail settings.

-Qualifications

UL Listed:E356272

Suitable for Wet Locations

-IESNA LM79 & LM-80 Testing:

LED luminaires have been tested by an independent laboratory in accordance with IESNALM-79 and LM-80

-DLC Qualification:

Selected models of this product are on the DesignLights Consortium (DLC) Qualified Products List and are eligible for rebates from DLC Member Utilities. To view our DLC qualified products, please consult the DLC Qualified Products List at www.designlights.org/qpl

-Construction

IP Rating:

Ingress Protection rating of IP65 for dust and water

Ambient Temperature:

Suitable for up to 122° F (50° C) ambient temperature

Cold Weather Starting:

The minimum starting temperature is -4°F /-20°C

Housing:

Bronze or Black Aluminum

Mounting Methods:

2" to pole top mount (refer to the dimensions on page 3)

Green Technology:

Mercury and UV free, and RoHS compliant. Polyester powder coat finish formulated without the use of VOC or toxic heavy metals.

Gaskets:

Silicon Gaskets

Lens:

Frosted or transparent GLASS lens optional.

Light shield ,Bird cone and ladder rest

Light shield ,Bird cone and ladder rest are **NOT** included as a standard structure. Please contact a sale representative to get a quote.

Finish:

Our environmentally friendly polyester powder coating are formulated from high-durability and long-lasting color, and contains no VOC or toxic heavy metals.

EPA (with Lens):1.57 sq. ft

-LED Characteristics**LEDs:**

Multi-chip, high-output, long-life LEDs Color

Stability:

LED color temperature is warrantied to shift no more than 200K in CCT over a 5 year period.

Color Temp:

3000 K(Warm white), 4000 K (Natural white), 5000 K(Daylight) or CCT 30K-40K-50K field selectable

Uniformity:

Range of CCT follows the guidelines of the American National Standards for the Specifications for the Chromaticity of Solid State Lighting (SSL) Products ,ANCI c78.377.2011

Color Rendering Index:

>70

-Electrial

Drivers:

100-277V, 50-60Hz,

Power Factor > 0.9

THD<15%

NEMA Receptacle:

3-prong twist lock receptacle with short-cap optional ; compatible with 3-pring Photocell Sensors.

7-prong twist lock receptacle with short-cap optional ; compatible with 7-pring Photocell Sensors.

-Ordering Matrix

Model	Wattage	Color Temperature	Lumens			G.W	Carton size
			3000K	4000K	5000K		
YR-TP350-W30	30	30K=3000K	2400	2700	3000	23.5 LBS	16in*16in*20in
YR-TP350-W50	50	40K=4000K	4000	4500	5000	23.5 LBS	16in*16in*20in
YR-TP350-W60	60	50K=5000K	4800	5400	6000	23.5 LBS	16in*16in*20in
YR-TP350-W80	80	57K=5700K	6400	7200	8000	23.5 LBS	16in*16in*20in
YR-TP350-W100	100		8000	9000	10000	23.5 LBS	16in*16in*20in
YR-TP350-W120	120		9600	10800	12000	23.5 LBS	16in*16in*20in
YR-TP350-W60-MTCP	30W-50W-60W tunable	30K-40K-50K tunable	4800	5400	6000	23.5 LBS	16in*16in*20in
YR-TP350-W100-MTCP	60W-80W-100W tunable	30K-40K-50K tunable	8000	9000	10000	23.5 LBS	16in*16in*20in

-Dimensions

2 3/8 inch mount base

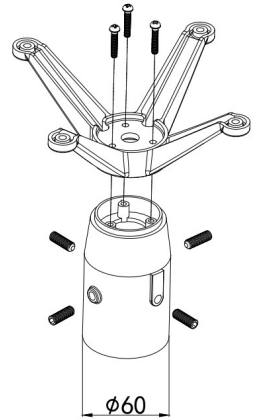
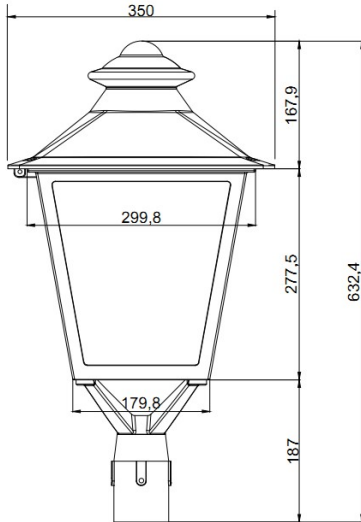

-Accessories

Surge Protector (Optional)

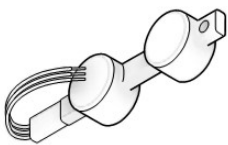

The SPD prevents downtime, improves reliability, and eliminates possible damage to luminaires. This the surge protector option for the luminaire has the maximum discharge current of 10,000A, and nominal discharge current of 3,000 A.

Photocell Assembly (Optional)

It is a Standard Three-Prong Twist Lock Photocell which is installed on the top of the Fixtures. Once the photocell is installed, the area light will automatically turn on and off, dusk to dawn.

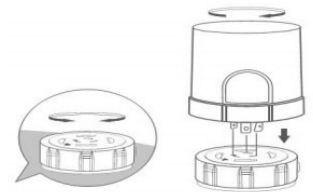

Microwave Motion Sensor (Optional)

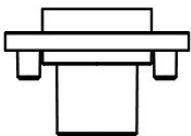

This motion sensor allows extra energy savings without compromising convenience. With its signature 3-step dimming function, it is perfect for use in areas that require a light change notice before optionally switching off the light. Daylight (on/off) sensor is integrated for maximum energy saving.

Hold Time adjustable:
5s / 1min / 5min / 10min / 15min / 20min / 30min / 1h

Stand-by period adjustable:
1min / 30min / 1h / infinity

Daylight (ambient light threshold) adjustable:
10lux / 30lux / 50lux / 100lux / 150lux / 200lux / 300lux / **Disable**

Stand-by dimming level adjustable:
0% / 20% / 30% / 50%