

## ProLED® LED TEMPORARY WORK LIGHT Installation Instructions



### Product Features and Specification model

- 60W, 100W, and 150W Options
- Integrated LED Lamp
- Daisy Chain with Plug and Socket having an anti-pull metal buckle
- 360 beam angle
- High Efficiency 120lm/w
- Long Life 50,000 hrs

\* The luminaire standard cable length is 15 ft \*

#### Option:

Watt	Input	Light effect	Lamp Dimension	Lamp Base	Maximum number of connection lamps	Operating temperature
60W			5.1" x 5.1" x 9.1"	Hand-held	10PCS	
100W	120Vac	120lm/W	5.1" x 5.1" x 10.9"	Tripod stand	6PCS	-30°C~60°C
150W			5.1" x 5.1" x 12.1"	Eyebolt	4PCS	

### Tripod Installation

Fig 1

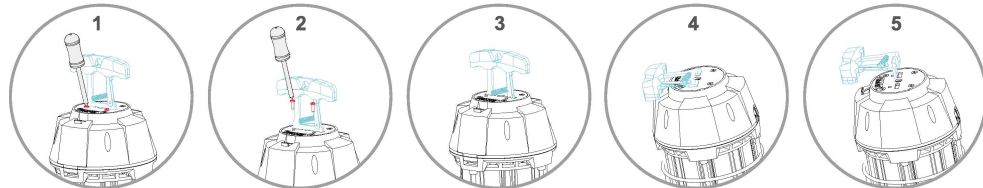

- 1, 2 Remove the screws;  
3, 4 bend the handle 90 degree;  
to the screw direction;  
5 lift and remove the handle;

Fig 2

#### Tripod installation

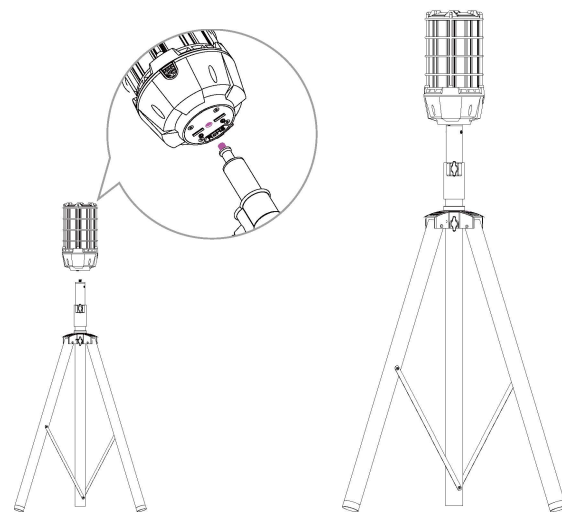

## ProLED® LED TEMPORARY WORK LIGHT Installation Instructions



### Installation instructions

1. Turn off the power before installation.
2. The installation steps for a single product are as step 1, step 2,
3. The installation steps for a 2 or more products are as step 1, step 2, step 3,
4. Close the cap for the last lamp which no need connect other lamps.
5. optional mounting (tripod) as Fig 1; optional mounting (eyebolt) as Fig 2

\* Reset fuse in driver in case of overload 5A, thus only the first lamp lighten up, disconnect the extra, the lamps will be lighten up when the fuse cool down, normally it takes 10 seconds.

### Installation diagram

Step:1

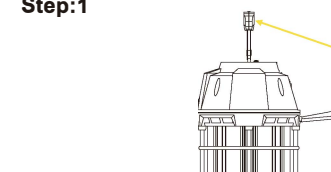

Hang on secure fixed wall or object by the base hook

Step:2

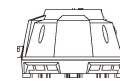

Ensure the fixed wall or object is strong enough to hold 66 lbs

Step:3

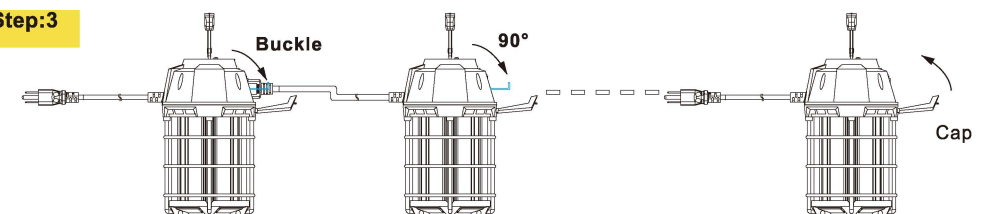

Connect the plug and socket to make sure 2 or more lamps be jointed together, and rotate the buckle 90° to make sure the lamps connected more firm.

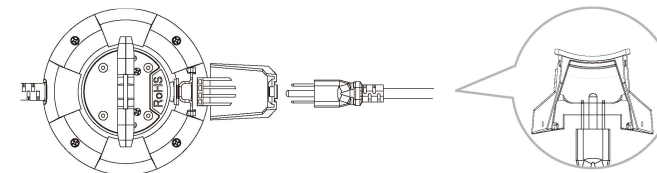

#### NOTICE

Total 5A max in parallel connection

### Warning

1. Please read this manual carefully before use, make sure the application is in accordance with the instructions before use.
2. To reduce the risk of electric shock and fire, do not exceed string maximum wattage including any additional string loads. Maximum number of connection lamps: 60W -10PCS, 100W-6PCS, 150W-4PCS.
3. They are suitable for dry and damp locations
4. Disconnect the power to avoid shock when the equipment is wet.
5. This device is not intended for use with emergency exits.
6. The product should not be installed in heat and sealed environment and corrosive gases, and other places, so as not to affect the service life.
7. Do not override any ignition of explosive materials on the surface, so as not to cause a fire.
8. This luminaire must be installed, tested and maintained by professionals using special equipment.
9. Please check the product carefully after open package, if any products damaged, please keep the packaging and contact to the local dealer.

### Warranty Information:

This product is warranted for five years from the date of purchase. If this product does not perform to the specifications supplied on this package, send an email or write to the address below for product return and replacement. This replacement is the sole remedy available. Liability for incidental or consequential damage is expressly excluded. Visit [www.halcolighting.com](http://www.halcolighting.com) for full warranty details and compatibility information.

Halco Lighting Technologies | 2940 Pacific Drive | Norcross, GA 30071 | Toll Free 800.677.3334 | Phone 770.242.3612 | Fax 800.880.0822 | [halcolighting.com](mailto:halcolighting.com)  
Atlanta | Chicago | Cleveland | Houston | Los Angeles | Phoenix  
©2021 Halco Lighting Technologies, LLC. All rights reserved. Halco is a registered trademark of Halco Lighting Technologies.  
All sizes and specifications are subject to change.