

**TOPSTAR™**

**LED TUBE**

Ballast Compatible  
LED T8 Lamps



# Easily upgrade to LED from fluorescent.

Topstar Ballast Compatible LED T8 Lamps are an ideal energy saving choice for existing linear fluorescent fixtures.

## Perfect for a wide range of applications

- Full light output in spaces with temperatures down to -4°F (-20°C)
- Perfect for applications with frequent “on/off” switching cycles
- Buildings that desire to be mercury free

## Easy to experience

- Instant on, no flicker or buzz
- Fits into existing linear fixtures
- Optimized performance with Electronic Ballasts
- Eliminates the need for rewiring and allows the fixture to maintain original UL and CSA compliance
- Power Factor >0.9\*
- THD <20%\*

## Material

- Frosted Glass

\* Tested with typical ballast

## Energy savings

- 50% energy savings vs F32T8 electronic instant start systems

## Easy to experience

- No mercury allowing for non-hazardous waste disposal
- Emits virtually no UV rays or IR
- Ideal light emitting, building comfortable living, and working environment
- 5-year limited warranty

## Low cost to retrofit

- Much labor cost is saved, because of easy replacement. Even one with little electrical experience, can achieve retrofit quickly and easily

1

**TOPSTAR™**

**Electrical and Technical Data (subject to change without notice)**

Ordering Code	Bare Lamp Watt (W)	Initial Lumen **	Base	CRI	Color Temp. *	Rated Average life	MOL (in.)	Beam Angle
● L24T8-8YY-08P-G6R-EB	8	1300	G13	82	3000K/3500K/4000K/5000K	50,000	24	160
● L36T8-8YY-09P-G6R-EB	9	1250	G13	82	3000K/3500K/4000K/5000K	50,000	36	160
● L48T8-8YY-11P-G6R-EB	11	1700	G13	82	3000K/3500K/4000K/5000K	50,000	48	160
● L48T8-8YY-13P-G6R-EB	13	2000	G13	82	3000K/3500K/4000K/5000K	50,000	48	160
● L48T8-8YY-14P-G6R-EB	14	2300	G13	82	3000K/3500K/4000K/5000K	50,000	48	160

- This Lamp is DLC4.4 Listed
- \* There is no inventory of 3000K in US.
- \*\* Initial Lumen is @ 4000K

Suitable for use where ambient temperature is between -4°F (-20°C) and 113°F (45°C).

FCC Note: This device complies with Part 18 of the FCC Rules.

**Installation Guide**

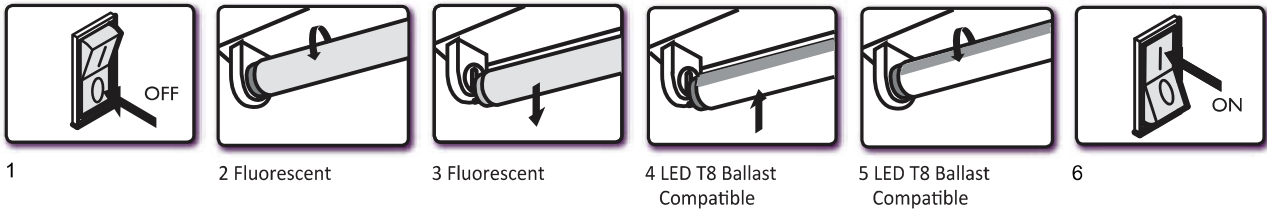

1. Switch-off power to the luminaire
2. Remove diffuser (if provided)
3. Remove the existing fluorescent lamps from the luminaire.
  - Note: Verify the fluorescent tube type is listed on the label of Wing LED T8 Ballast Compatible lamp.
- 4-5. Install the LED T8 Ballast Compatible lamp (One for each fluorescent lamp removed, ensure pins are firmly seated in lampholders).
  - Replace diffuser (if removed in step 2).
6. Switch on power to the luminaire.

**CAUTION**

- If the lamp or luminaire exhibits undesirable operation (buzzing, flickering, etc.), immediately turn off power, remove lamp from luminaire and contact the manufacturer
- Risk of Fire. Do not install in a pre-heat luminaire

**WARNING**

- Risk of fire, use only in place of fluorescent lamps specified on label. See instructions.
- This lamp only operates on electronic ballasts. If lamp does not light when the luminaire is energized, remove lamp from luminaire and contact lamp manufacturer or qualified electrician.
- This product may cause interference to radio equipment and should not be installed near maritime safety communications equipment or other critical navigation or communication equipment operating between 0.45-30 MHz.