

T8 Type A Ballast Compatible T8 LED tube

Indoor



ATG Type A Ballast Compatible LED T8 Lamps are an ideal energy saving choice for existing linear fluorescent fixtures. These lamps emit smooth and comfortable light quality -supporting a comfortable living and working environment.

| Luminaire | Type A Ballast Compatible T8 | Type |
|-----------|------------------------------|------|
| Project | | |
| Product | | |
| Notes | | |



Features

- 50% energy savings vs F32T8 electronics instant start systems
- Simple Plug and play. No wiring, no tools, no extra steps.
- Instant On. No warm-up time required. Full brightness instantly.
- Compatible with instant start ballasts.
- Efficacy up to 157 LPW



Application

Full light output in spaces with temperatures down to -4°F (-20°C). Perfect for applications with frequent “on/off” switching cycles. Even one with little electrical experience, can achieve retrofit quickly and easily.

Construction

The glass tube is coated in a light-diffusing “frost”. No mercury allowing for non-hazardous waste disposal.

Electrical

Easy to experience - instant on, no flicker or buzz. Fits into existing linear fixtures. Optimized performance with Electronic Ballasts. Eliminates the need for re wiring and allows the fixture to maintain original UL and CSA compliance.

| | |
|----------------------------|--|
| Power (W) | 11,14 |
| Input Voltage (VAC) | 120-277 50/60 Hz |
| CRI | 82 |
| CCT(K) | *3,000, *3,500, 4,000, 5,000 |
| L70 (Hours) | 50,000 |
| Base | G13 |
| Installation Type | UL, Type A, Direct Replacement |
| PF | >.9 |
| THD | <20% |
| Housing | Frosted Glass |
| Lens | Glass 160° beam angle, 325° light emitting zone |
| Temperature | -4°F (-20°C) to 113°F (45°C) |
| Warranty | 5 Years |
| Length | 4 ft |

Optics

The lamp's light-diffusing frosted glass tube and compact light engine produce a wide beam 325° of evenly diffused light. Emits virtually no UV rays or IR.

Certifications/Listings

- UL
- FCC
- RoHS

Lumens

| Model | Watts | Lumens | CCT | CRI | Efficacy | Angle | PF | THD | Instant Shipping | Listing |
|-----------------|-------|--------|-------|-----|----------|-------|------|-----|------------------|-------------|
| T8F4G-11-830-DR | 11W | 1650LM | 3000K | 82 | 150 LPW | 160° | 0.9 | 20% | No | UL/DLC/RoHS |
| T8F4G-11-835-DR | 11W | 1650LM | 3500K | 82 | 150LPW | 160° | 0.9 | 20% | No | UL/DLC/RoHS |
| T8F4G-11-840-DR | 11W | 1700LM | 4000K | 82 | 155LPW | 160° | 0..9 | 20% | Yes | UL/DLC/RoHS |
| T8F4G-11-850-DR | 11W | 1700LM | 5000K | 82 | 155LPW | 160° | 0.9 | 20% | Yes | UL/DLC/RoHS |
| T8F4G-14-830-DR | 14W | 2100LM | 3000K | 82 | 150LPW | 160° | 0.9 | 20% | No | UL/DLC/RoHS |
| T8F4G-14-835-DR | 14W | 2100LM | 3500K | 82 | 150LPW | 160° | 0.9 | 20% | No | UL/DLC/RoHS |
| T8F4G-14-840-DR | 14W | 2300LM | 4000K | 82 | 157LPW | 160° | 0.9 | 20% | Yes | UL/DLC/RoHS |
| T8F4G-14-850-DR | 14W | 2300LM | 5000K | 82 | 157LPW | 160° | 0.9 | 20% | Yes | UL/DLC/RoHS |

Installation Instructions

Installation Guide

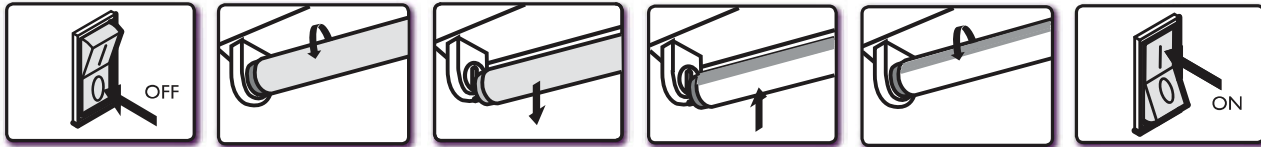

1

2 Fluorescent

3 Fluorescent

4 LED T8 Ballast
Compatible

5 LED T8 Ballast
Compatible

6

1. Switch-off power to the luminaire
2. Remove diffuser (if provided)
3. Remove the existing fluorescent lamps from the luminaire.
 - Note: Verify the fluorescent tube type is listed on the label of Wing LED T8 Ballast Compatible lamp.
- 4-5. Install the LED T8 Ballast Compatible lamp (One for each fluorescent lamp removed, ensure pins are firmly seated in lampholders).
 - Replace diffuser (if removed in step 2).
6. Switch on power to the luminaire.

CAUTION

- If the lamp or luminaire exhibits undesirable operation (buzzing, flickering, etc.), immediately turn off power, remove lamp from luminaire and contact the manufacturer
- Risk of Fire. Do not install in a pre-heat luminaire

WARNING

- Risks of fire, use only in place of fluorescent lamps specified on label. See instructions.

This lamp only operates on electronic ballasts. If lamp does not light when the luminaire is energized, remove lamp from luminaire and contact lamp manufacturer or qualified electrician.

This product may cause interference to radio equipment and should not be installed near maritime safety communications equipment or other critical navigation or communication equipment operating between 0.45-30 MHz.

T8 Type A Ballast Compatible T8 LED tube Indoor



| Ballast Brand | Part Number | Start Type | # of Lamps | Compatibility | | Ballast Brand | Part Number | Start Type | # of Lamps | Compatibility | |
|---------------|-----------------|---------------|------------|---------------|------|---------------|-----------------|---------------|------------|---------------|------|
| | | | | 120V | 277V | | | | | 120V | 277V |
| PHILIPS | IOPA-1 P32-N | INSTANT START | 1 | 120V | ✓ | PHILIPS | IZT-2PSP32-LW-N | PROGRAM START | 1 | 120V | ✓ |
| | | | | 277V | ✓ | | | | | 277V | ✓ |
| PHILIPS | ICN-1P32-N | INSTANT START | 1 | 120V | ✓ | PHILIPS | VEZ-2S32-SC | PROGRAM START | 2 | 120V | ✓ |
| | | | | 277V | ✓ | | | | | 277V | ✓ |
| PHILIPS | IOPA-1 P32-LW-N | INSTANT START | 1 | 120V | ✓ | PHILIPS | VEZ-1 S32-SC | PROGRAM START | 1 | 277V | x |
| | | | | 277V | ✓ | | | | | 277V | ✓ |
| PHILIPS | IZT-132-SC | PROGRAM START | 1 | 120V | ✓ | PHILIPS | VEZ-1 S32-SC | PROGRAM START | 1 | 277V | ✓ |
| | | | | 277V | ✓ | | | | | 277V | ✓ |
| PHILIPS | ICN-1 P32-MC | INSTANT START | 1 | 120V | ✓ | PHILIPS | IOPA-2P32-HL-SC | INSTANT START | 1 | 120V | x |
| | | | | 277V | ✓ | | | | | 277V | x |
| PHILIPS | ICN-2P32-N | INSTANT START | 1 | 120V | x | PHILIPS | REZ-232-SC | PROGRAM START | 1 | 120V | x |
| | | | | 277V | x | | | | | 277V | ✓ |
| | | | 2 | 120V | ✓ | | | | 2 | 120V | ✓ |
| | | | | 277V | ✓ | | | | 277V | ✓ | |
| PHILIPS | IOPA-2P32-LW-N | INSTANT START | 1 | 120V | ✓ | PHILIPS | ICN-3P32-N | INSTANT START | 2 | 120V | ✓ |
| | | | | 277V | ✓ | | | | | 277V | ✓ |
| | | | 2 | 120V | ✓ | | | | 3 | 120V | ✓ |
| | | | | 277V | ✓ | | | | | 277V | ✓ |
| PHILIPS | IOP-2P32-LW-N | INSTANT START | 1 | 120V | ✓ | PHILIPS | IOPA-3P32-N | INSTANT START | 2 | 120V | ✓ |
| | | | | 277V | ✓ | | | | | 277V | ✓ |
| | | | 2 | 120V | ✓ | | | | 3 | 120V | ✓ |
| | | | | 277V | ✓ | | | | | 277V | ✓ |
| PHILIPS | IOP-1 P32-LW-N | INSTANT START | 1 | 120V | ✓ | PHILIPS | IOPA-3P32-HL-N | INSTANT START | 2 | 120V | x |
| | | | | 277V | ✓ | | | | | 277V | x |
| PHILIPS | IOPA-2P32-N | INSTANT START | 1 | 120V | ✓ | PHILIPS | IOPA-3P32-LW-N | INSTANT START | 2 | 120V | ✓ |
| | | | | 277V | ✓ | | | | | 277V | ✓ |
| | | | 2 | 120V | ✓ | | | | 3 | 120V | ✓ |
| | | | | 277V | ✓ | | | | | 277V | ✓ |
| PHILIPS | REZ-132-SC | PROGRAM START | 1 | 120V | ✓ | PHILIPS | IOP-3P32-HL-N | INSTANT START | 2 | 120V | x |
| | | | | 277V | ✓ | | | | | 277V | x |
| | | | 2 | 120V | x | | | | 3 | 120V | ✓ |
| | | | | 277V | x | | | | | 277V | ✓ |
| PHILIPS | IOP-2PSP32-LW-N | INSTANT START | 1 | 120V | ✓ | PHILIPS | IOP-3P32-N | INSTANT START | 2 | 120V | ✓ |
| | | | | 277V | ✓ | | | | | 277V | ✓ |
| | | | 2 | 120V | ✓ | | | | 3 | 120V | ✓ |
| | | | | 277V | ✓ | | | | | 277V | ✓ |
| PHILIPS | IZT-2PSP32-SC | PROGRAM START | 1 | 120V | ✓ | PHILIPS | ICN-4P32-N | INSTANT START | 3 | 120V | ✓ |
| | | | | 277V | ✓ | | | | | 277V | ✓ |
| | | | 2 | 120V | ✓ | | | | 4 | 120V | ✓ |
| | | | | 277V | ✓ | | | | | 277V | ✓ |
| PHILIPS | REL-2P32-SC | INSTANT START | 1 | 120V | ✓ | PHILIPS | ICN-4P32-SC | INSTANT START | 3 | 120V | ✓ |
| | | | | 277V | ✓ | | | | | 277V | ✓ |
| | | | 2 | 120V | ✓ | | | | 4 | 120V | ✓ |
| | | | | 277V | ✓ | | | | | 277V | ✓ |
| | | | 3 | 120V | ✓ | | | | 4 | 120V | ✓ |
| | | | | 277V | ✓ | | | | | 277V | ✓ |
| | | | 4 | 120V | ✓ | | | | 4 | 120V | ✓ |
| | | | | 277V | x | | | | | 277V | ✓ |
| PHILIPS | REL-2P32-RH-TP | INSTANT START | 1 | 120V | x | PHILIPS | ICN-4P32-SC | INSTANT START | 4 | 120V | ✓ |
| | | | | 277V | x | | | | | 277V | ✓ |
| PHILIPS | REL-2P32-RH-TP | INSTANT START | 2 | 120V | x | PHILIPS | ICN-4P32-SC | INSTANT START | 4 | 120V | ✓ |
| | | | | 277V | x | | | | | 277V | ✓ |

T8 Type A Ballast Compatible T8 LED tube

Indoor



| Ballast Brand | Part Number | Start Type | # of Lamps | Compatibility | |
|---------------|-------------------------|---------------|------------|---------------|------|
| | | | | 120V | 277V |
| PHILIPS | IOPA-4P32-N | INSTANT START | 3 | 120V | ✓ |
| | | | | 277V | ✓ |
| | | | 4 | 120V | ✓ |
| | | | | 277V | ✓ |
| PHILIPS | IOP-4P32-LW-N | INSTANT START | 3 | 120V | ✓ |
| | | | | 277V | ✓ |
| | | | 4 | 120V | ✓ |
| | | | | 277V | ✓ |
| PHILIPS | GOPA-2P32-N | INSTANT START | 1 | 347V | ✓ |
| | | | 2 | 347V | ✓ |
| PHILIPS | GOPA-4P32-N | INSTANT START | 3 | 347V | ✓ |
| | | | 4 | 347V | ✓ |
| PHILIPS | IOPA-4P32-SC | INSTANT START | 3 | 120V | x |
| | | | | 277V | ✓ |
| | | | 4 | 120V | x |
| | | | | 277V | ✓ |
| GE | GE-232-MV-N | INSTANT START | 1 | 120V | ✓ |
| | | | | 277V | ✓ |
| | | | 2 | 120V | ✓ |
| | | | | 277V | ✓ |
| GE | GE232MAX-N/ UL TRA | INSTANT START | 1 | 120V | ✓ |
| | | | | 277V | ✓ |
| | | | 2 | 120V | ✓ |
| | | | | 277V | ✓ |
| GE | GEI 32MAXP-N/ UL TRA | INSTANT START | 1 | 120V | ✓ |
| | | | | 277V | ✓ |
| GE | GE232MAXP-N/ UL TRA | INSTANT START | 1 | 120V | ✓ |
| | | | | 277V | ✓ |
| | | | 2 | 120V | ✓ |
| | | | | 277V | ✓ |
| GE | GE232MAX-L/ UL TRA | INSTANT START | 1 | 120V | ✓ |
| | | | | 277V | ✓ |
| | | | 2 | 120V | ✓ |
| | | | | 277V | ✓ |
| GE | GE232MAXP-L/ UL TRA | INSTANT START | 1 | 120V | ✓ |
| | | | | 277V | ✓ |
| | | | 2 | 120V | ✓ |
| | | | | 277V | ✓ |
| GE | GE232MAX-H/ UL TRA | INSTANT START | 1 | 120V | x |
| | | | | 277V | x |
| | | | 2 | 120V | ✓ |
| | | | | 277V | ✓ |
| GE | GE232MAXP-H/ UL TRA | INSTANT START | 1 | 120V | x |
| | | | | 277V | x |
| | | | 2 | 120V | ✓ |
| | | | | 277V | ✓ |
| GE | GE-232-MV-PS-N | PROGRAM START | 1 | 120V | ✓ |
| | | | | 277V | ✓ |
| | | | 2 | 120V | ✓ |
| | | | | 277V | ✓ |

| Ballast Brand | Part Number | Start Type | # of Lamps | Compatibility | |
|---------------|------------------------|---------------|------------|---------------|------|
| | | | | 120V | 277V |
| GE | GE-232-MV-PS-H | PROGRAM START | 1 | 120V | X |
| | | | | 277V | X |
| | | | 2 | 120V | ✓ |
| | | | | 277V | ✓ |
| GE | GE232MVPS-N-V03 | PROGRAM START | 1 | 120V | ✓ |
| | | | | 277V | ✓ |
| | | | 2 | 120V | ✓ |
| | | | | 277V | ✓ |
| GE | GE332MAX-N/ UL TRA | INSTANT START | 2 | 120V | ✓ |
| | | | | 277V | ✓ |
| | | | 3 | 120V | ✓ |
| | | | | 277V | ✓ |
| GE | GE332-MV-N | INSTANT START | 2 | 120V | ✓ |
| | | | | 277V | ✓ |
| | | | 3 | 120V | ✓ |
| | | | | 277V | ✓ |
| GE | GE232MAXP-H/ UL TRA | INSTANT START | 1 | 120V | X |
| | | | | 277V | X |
| | | | 2 | 120V | ✓ |
| | | | | 277V | ✓ |
| GE | GE332MAXP-N/ UL TRA | INSTANT START | 2 | 120V | ✓ |
| | | | | 277V | ✓ |
| | | | 3 | 120V | ✓ |
| | | | | 277V | ✓ |
| GE | GE332MAXP-H/ UL TRA | INSTANT START | 2 | 120V | x |
| | | | | 277V | x |
| | | | 3 | 120V | ✓ |
| | | | | 277V | ✓ |
| GE | GE332MAX-H/ UL TRA | INSTANT START | 2 | 120V | x |
| | | | | 277V | x |
| | | | 3 | 120V | ✓ |
| | | | | 277V | ✓ |
| GE | GE332MAXP-L/ UL TRA | INSTANT START | 2 | 120V | ✓ |
| | | | | 277V | ✓ |
| | | | 3 | 120V | ✓ |
| | | | | 277V | ✓ |
| GE | GE432MAX-G-N | INSTANT START | 3 | 120V | ✓ |
| | | | | 277V | ✓ |
| | | | 4 | 120V | ✓ |
| | | | | 277V | ✓ |
| GE | GE432MAX-N/ ULTRA | INSTANT START | 3 | 120V | ✓ |
| | | | | 277V | ✓ |
| | | | 4 | 120V | ✓ |
| | | | | 277V | ✓ |
| GE | GE432MAXP-H/ ULTRA | INSTANT START | 3 | 120V | ✓ |
| | | | | 277V | ✓ |
| | | | 4 | 120V | ✓ |
| | | | | 277V | ✓ |

T8 Type A Ballast Compatible T8 LED tube

Indoor



| Ballast Brand | Part Number | Start Type | # of Lamps | Compatibility | |
|---------------|---------------------------|------------------|------------|---------------|---|
| GE | GE432MAX-L/ ULTRA | INSTANT START | 3 | 120V | ✓ |
| | | | | 277V | ✓ |
| | | | 4 | 120V | ✓ |
| | | | | 277V | ✓ |
| GE | GE432MAXP-L/U LTRA | INSTANT START | 3 | 120V | ✓ |
| | | | | 277V | ✓ |
| | | | 4 | 120V | ✓ |
| | | | | 277V | ✓ |
| GE | GE232MAX347-N | INSTANT START | 1 | 347V | ✓ |
| | | | 2 | 347V | ✓ |
| OSRAM | QTP 2X32T8 UNY ISN-SC | INSTANT START | 1 | 120V | ✓ |
| | | | | 277V | ✓ |
| | | | 2 | 120V | ✓ |
| | | | | 277V | ✓ |
| OSRAM | QTP 1 X32T8 UNY ISN-SC | INSTANT START | 1 | 120V | ✓ |
| | | | | 277V | ✓ |
| OSRAM | QTP 2X32T8 UNY ISL-SC | INSTANT START | 1 | 120V | ✓ |
| | | | | 277V | ✓ |
| | | | 2 | 120V | ✓ |
| | | | | 277V | ✓ |
| OSRAM | QHE 2X32T8 UNY PSN-MC | PROGRAM START | 1 | 120V | ✓ |
| | | | | 277V | ✓ |
| | | | 2 | 120V | ✓ |
| | | | | 277V | ✓ |
| OSRAM | QHE 2X32T8 UNY DIM-TC | PROGRAM START | 1 | 120V | X |
| | | | | 277V | X |
| | | | 2 | 120V | ✓ |
| | | | | 277V | ✓ |
| OSRAM | QTP 3X32T8/ UNY ISN-SC | INSTANT START | 2 | 120V | ✓ |
| | | | | 277V | ✓ |
| | | | 3 | 120V | ✓ |
| | | | | 277V | ✓ |
| OSRAM | QHE 4X32T8/ UNY ISL-SC | INSTANT START | 3 | 120V | ✓ |
| | | | | 277V | ✓ |
| | | | 4 | 120V | ✓ |
| | | | | 277V | ✓ |
| OSRAM | QTP 4X32T8/ UNY ISN-SC | INSTANT START | 3 | 120V | ✓ |
| | | | | 277V | ✓ |
| | | | 4 | 120V | ✓ |
| | | | | 277V | ✓ |
| OSRAM | QHE 4X32T8/ UNY PSN-SC | PROGRAM START | 3 | 120V | ✓ |
| | | | | 277V | ✓ |
| | | | 4 | 120V | ✓ |
| | | | | 277V | ✓ |
| KEYSTONE | KTEB-232-UV- IS-L-P | INSTANT START | 1 | 120V | ✓ |
| | | | | 277V | ✓ |
| | | | 2 | 120V | ✓ |
| | | | | 277V | ✓ |

| Ballast Brand | Part Number | Start Type | # of Lamps | Compatibility | |
|---------------|------------------------|------------------|------------|---------------|---|
| KEYSTONE | KTEB-232-UV- IS-H-P | INSTANT START | 1 | 120V | x |
| | | | | 277V | x |
| | | | 2 | 120V | ✓ |
| | | | | 277V | ✓ |
| KEYSTONE | KTEB-332-UV- IS-N-P | INSTANT START | 2 | 120V | ✓ |
| | | | | 277V | ✓ |
| | | | 3 | 120V | ✓ |
| | | | | 277V | ✓ |
| KEYSTONE | KTEB-332-UV- IS-L-P | INSTANT START | 2 | 120V | ✓ |
| | | | | 277V | ✓ |
| | | | 3 | 120V | ✓ |
| | | | | 277V | ✓ |
| KEYSTONE | KTEB-332-UV- IS-H-P | INSTANT START | 2 | 120V | x |
| | | | | 277V | x |
| | | | 3 | 120V | ✓ |
| | | | | 277V | ✓ |
| KEYSTONE | KTEB-432-UV- IS-N-P | INSTANT START | 3 | 120V | ✓ |
| | | | | 277V | ✓ |
| | | | 4 | 120V | ✓ |
| | | | | 277V | ✓ |
| KEYSTONE | KTEB-432-UV- IS-L-P | INSTANT START | 3 | 120V | ✓ |
| | | | | 277V | ✓ |
| | | | 4 | 120V | ✓ |
| | | | | 277V | ✓ |
| KEYSTONE | KTEB-432-UV- IS-H-P | INSTANT START | 3 | 120V | x |
| | | | | 277V | x |
| | | | 4 | 120V | ✓ |
| | | | | 277V | ✓ |
| KEYSTONE | KTEB-232-UV- PS-N-P | PROGRAM START | 1 | 120V | ✓ |
| | | | | 277V | ✓ |
| | | | 2 | 120V | ✓ |
| | | | | 277V | ✓ |
| KEYSTONE | KTEB-232-UV- PS-L-P | PROGRAM START | 1 | 120V | x |
| | | | | 277V | x |
| | | | 2 | 120V | ✓ |
| | | | | 277V | ✓ |
| KEYSTONE | KTEB-232-UV- PS-H-P | PROGRAM START | 2 | 120V | ✓ |
| | | | | 277V | ✓ |
| | | | 3 | 120V | ✓ |
| | | | | 277V | ✓ |
| KEYSTONE | KTEB-332-UV- PS-N-P | PROGRAM START | 2 | 120V | ✓ |
| | | | | 277V | ✓ |
| | | | 3 | 120V | ✓ |
| | | | | 277V | ✓ |
| KEYSTONE | KTEB-332-UV- PS-H-P | PROGRAM START | 2 | 120V | x |
| | | | | 277V | x |
| | | | 3 | 120V | ✓ |
| | | | | 277V | ✓ |

T8 Type A Ballast Compatible T8 LED tube Indoor



| Ballast Brand | Part Number | Start Type | # of Lamps | Compatibility | |
|---------------|--------------------|---------------|------------|---------------|---|
| | | | | 120V | ✓ |
| KEYSTONE | KTEB-332-UV-PS-L-P | PROGRAM START | 2 | 120V | ✓ |
| | | | | 277V | ✓ |
| | | | 3 | 120V | ✓ |
| | | | | 277V | ✓ |
| KEYSTONE | KTEB-432-UV-PS-L-P | PROGRAM START | 3 | 120V | ✓ |
| | | | | 277V | ✓ |
| | | | 4 | 120V | ✓ |
| | | | | 277V | ✓ |
| KEYSTONE | KTEB-432-UV-PS-N-P | PROGRAM START | 3 | 120V | ✓ |
| | | | | 277V | ✓ |
| | | | 4 | 120V | ✓ |
| | | | | 277V | ✓ |
| UNIVERSAL | B132IUNVHP-N | INSTANT START | 1 | 120V | ✓ |
| UNIVERSAL | B232IUNVHP-N | INSTANT START | 1 | 120V | ✓ |
| | | | | 277V | ✓ |
| UNIVERSAL | B232PUNVHE-B | INSTANT START | 1 | 120V | ✓ |
| | | | | 277V | ✓ |
| UNIVERSAL | B232PUS50-A | PROGRAM START | 3 | 120V | ✓ |
| | | | | 277V | ✓ |
| UNIVERSAL | B332IUNVHP-A | INSTANT START | 2 | 120V | ✓ |
| | | | | 277V | ✓ |
| UNIVERSAL | B432IUNVHP-A | INSTANT START | 3 | 120V | ✓ |
| | | | | 277V | ✓ |
| UNIVERSAL | B432IUNVHP-N | INSTANT START | 3 | 120V | ✓ |
| | | | | 277V | ✓ |
| FALHAM | WH5-120-L | INSTANT START | 3 | 120V | ✓ |
| | | | | 277V | ✓ |
| FALHAM | WH7-120-L | INSTANT START | 3 | 120V | x |
| | | | | 277V | x |
| FALHAM | WH3-120-L | INSTANT START | 1 | 120V | ✓ |
| | | | | 277V | ✓ |

| Ballast Brand | Part Number | Start Type | # of Lamps | Compatibility | |
|---------------|------------------------|---------------|------------|---------------|---|
| | | | | 120V | ✓ |
| ESPEN | VE2P32MVHIPE | INSTANT START | 1 | 120V | ✓ |
| | | | | 277V | ✓ |
| | | | 2 | 120V | ✓ |
| | | | | 277V | ✓ |
| ESPEN | VE2P32MVHIPHE | INSTANT START | 1 | 120V | ✓ |
| | | | | 277V | ✓ |
| | | | 2 | 120V | ✓ |
| | | | | 277V | ✓ |
| ESPEN | VE232MVHIPHE | INSTANT START | 1 | 120V | x |
| | | | | 277V | x |
| | | | 2 | 120V | ✓ |
| | | | | 277V | ✓ |
| ESPEN | VE3P32MVHIPE | INSTANT START | 2 | 120V | ✓ |
| | | | | 277V | ✓ |
| | | | 3 | 120V | ✓ |
| | | | | 277V | ✓ |
| HOWARD | EP3/32IS/MV / MC/HE | INSTANT START | 2 | 120V | ✓ |
| | | | | 277V | ✓ |
| | | | 3 | 120V | ✓ |
| | | | | 277V | ✓ |
| HOWARD | EPL3/32IS/ M V / SC/HE | INSTANT START | 2 | 120V | ✓ |
| | | | | 277V | ✓ |
| | | | 3 | 120V | ✓ |
| | | | | 277V | ✓ |
| Plusrite | BAF332IS/MV | INSTANT START | 2 | 120V | ✓ |
| | | | | 277V | ✓ |
| | | | 3 | 120V | ✓ |
| | | | | 277V | ✓ |
| Plusrite | BAF232IS/MV | INSTANT START | 1 | 120V | ✓ |
| | | | | 277V | ✓ |
| | | | 2 | 120V | ✓ |
| | | | | 277V | ✓ |
| Plusrite | BAF232IS/MV /H | INSTANT START | 1 | 120V | ✓ |
| | | | | 277V | ✓ |
| | | | 2 | 120V | ✓ |
| | | | | 277V | ✓ |
| SUNPARK | U-2/32ISE | INSTANT START | 1 | 120V | ✓ |
| | | | | 277V | ✓ |
| | | | 2 | 120V | ✓ |
| | | | | 277V | ✓ |
| ROBERTSON | ISU232T8120 | INSTANT START | 1 | 120V | ✓ |
| | | | | 277V | ✓ |
| | | | 2 | 120V | ✓ |
| | | | | 277V | ✓ |
| POWERMASTER | PM-2X32T8-UNV-IS-L | INSTANT START | 1 | 120V | ✓ |
| | | | | 277V | ✓ |
| | | | 2 | 120V | ✓ |
| | | | | 277V | ✓ |
| POWERMASTER | PM-3X32T8-U NV-IS-H | INSTANT START | 2 | 120V | x |
| | | | | 277V | ✓ |
| | | | 3 | 120V | x |
| | | | | 277V | ✓ |

T8 Type A Ballast Compatible T8 LED tube Indoor



| Ballast Brand | Part Number | Start Type | # of Lamps | Compatibility | | Emergency Ballast Compatibility | | | |
|---------------|-----------------------|---------------|------------|---------------|------|---------------------------------|----------------|---------------|---|
| | | | | 120V | 277V | Brand | Model | Compatibility | |
| POWERMASTER | PM-4X32T8-UNV-IS-L | INSTANT START | 3 | 120V | x | Bodine | B30ST | √ | |
| | | | | 277V | √ | | B50 | √ | |
| | | | 4 | 120V | x | | B54 | √ | |
| | | | | 277V | √ | | B60 | √ | |
| TCP | E4P32PSUNVE | INSTANT START | 3 | 120V | √ | | B100 | √ | |
| | | | | 277V | √ | | LPSS0 | √ | |
| | | | 4 | 120V | √ | | LP600 | √ | |
| | | | | 277V | √ | | Iota | I-42-EM-R-J | √ |
| ESPEN | VE4P32MVHIPE | INSTANT START | 3 | 120V | √ | | | ICE-80 | √ |
| | | | | 277V | √ | | | I-320 | √ |
| | | | 4 | 120V | √ | | | I-232 | √ |
| | | | | 277V | √ | | | 1-232 | √ |
| Premium | P M-2X32T8-U NV-IS-L2 | INSTANT START | 2 | 120V | √ | 1-62 | | √ | |
| | | | | 277V | √ | 1-32 | | √ | |
| Premium | BB-T8/UNH-4X32 | INSTANT START | 3 | 120V | x | ISL-54 | | √ | |
| | | | | 277V | √ | ISL-540 | | √ | |
| | | | 4 | 120V | x | ISD-80 | | √ | |
| | | | | 277V | √ | Lithonia | | EIS00 | √ |
| Fulham | ALP | EFP 32GS | √ | PSQS00QD | √ | | | | |
| | | | √ | PS1400QD | √ | | | | |
| | | | √ | FH4-DUAL-700L | √ | | | | |
| | | | | | | √ | FH3-DUAL-450L | √ | |
| | | | | | | √ | FHS-DUAL-1400L | √ | |

| 0-10V Dimmability | | | | | | |
|-------------------|------------|-------------|-------|------------|---------------|-----------------------|
| Brand | Series | Model | Load | Ballast | | |
| | | | | Philips | | Sylvania |
| | | | | IZT-132-SC | IZT-2PSP32-SC | QHE 2x32T8/UNV DIM-TC |
| Lutron | Diva | DVTV | 960W | OK | OKw/Noise | OK |
| | Diva | DVSTV | 1000W | OK | OKw/Noise | OK |
| | Nova | NTSTV-DV | 960W | OK | OKw/Noise | OK |
| Legrand | Adorne | ADPD4FBL3P2 | 700W | OK | OKw/Noise | OK |
| | Harmony | H4FBL3P | 1200W | OK | OKw/Noise | OK |
| Leviton | Illumatech | IP710-DLZ | 1200W | OK | OKw/Noise | OK |

AES has provided this dimmer compatibility chart for guidance when selecting a ballast, dimmer and lamp combination. Lamps were tested for compatibility with the above listed ballasts and dimmers. Ballasts and dimmers that do not appear on the chart might still be compatible but have not been tested. All testing has been performed with a stable main supply. The quality of the local main, existing installation and wiring, as well as different manufacturer versions of the above ballasts may affect lamp performance. Since no assurance can be provided regarding these factors, it is a general recommendation to perform a test on-sit prior to installing the LED lamps.