

Occupancy Motion Sensor Light Switch

UNIVERSAL COMPATIBILITY

Works with 99% of LED, CFL and incandescent light bulbs.



Incandescent Lamp

600W / 120-270V



CFL Lamp

300W / 120-270V



LED Lamp

300W / 120-270V

FEATURE

- **Universal Compatibility:** Works with 300W LED/300W CFL/600W incandescent light bulbs
- **Multiple Control:** Can be used as single-pole or 2 location control. Features multiple setting modes of Automatic or Manual ON/OFF for different usage scenarios at home. (NOT suitable for 3 way circuit)
- **No Neutral Wire Required:** Ideal for homes of all ages. Replace existing switch or sensor in as little as 15 minutes. Ultra slim profile, easily fits in electrical box and wall plate
- **High Quality + Modern Design:** Energy saving and long operating life. Flame resistant material has reached the highest grade of 5VA. Wall Plate included.
- **UL & CUL listed.**

COVERAGE

The sensor detects motion in areas up to 900 square feet and up to 35 feet from the sensor.

Ideal for porch, closet, garage, hallway, stairs, basement, pantry and laundry room, etc.

Tips: Install the sensor switch about 4 feet from the floor to get better experience.

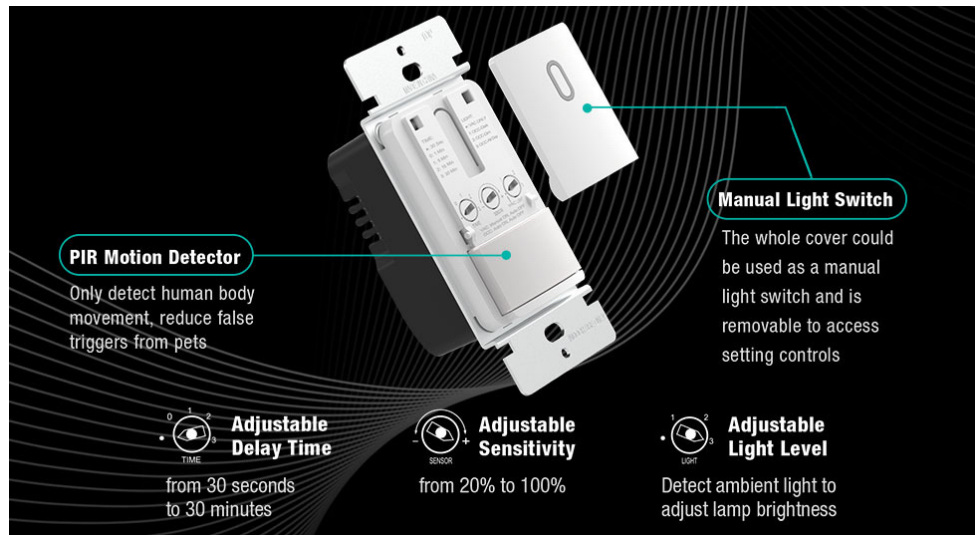

INSTALLATION GUIDE



Step 1

Pry off cover here



Step 2

Set the dials of TIME, SENSOR and LIGHT after cover is off. See the chart for the description of TIME and LIGHT setting.

MULTIPLE SETTING MODES

TIME	DESCRIPTION
•	Test Mode: Automatically turn off the loads after 30 seconds
0	Automatically turn off the loads after 1 minute
1	Automatically turn off the loads after 5 minutes
2	Automatically turn off the loads after 15 minutes
3	Automatically turn off the loads after 30 minutes
LIGHT	DESCRIPTION
•	VAC Mode: Manual ON and Auto OFF when time delay elapses
1	OCC Mode: Auto ON and Auto OFF in dark ambient light
2	OCC Mode: Auto ON and Auto OFF in dim ambient light
3	OCC Mode: Auto ON and Auto OFF in any ambient light, including the bright day

Grounding Wire is Required

The sensor will not function if it's false wired or un-grounded
No Neutral Wire Required

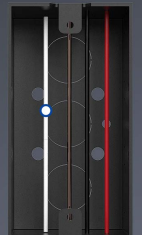
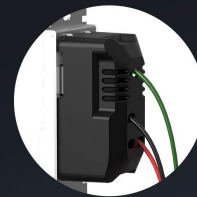

Ground
Hot
Load