



LOC-FL-MWMCCT Series Installation Guide

SAFETY INSTRUCTIONS: Read instructions carefully before attempting to install fixture.

- All wiring should be performed by a qualified electrician.
- Disconnect power before installing or servicing. This fixture must be wired in accordance with the National Electrical Code and applicable local codes and ordinances.
- Proper grounding is required to ensure personal safety.
- Recommended to be stored in -45°C to 45°C (-49°F to 113°F).
- To ensure weatherproof seal, apply weatherproof silicone sealant around the edge of the junction box (not supplied).

CAUTION: Risk of fire

- **WARNING:** Make certain power is OFF before installing or maintaining fixture. No user serviceable parts inside.
- **WARNING:** Risk of shock when photoelectric switch is provided.
- **WARNING:** Please check if the voltage marked on the luminaire is consistent with the input voltage to be connected.
- **WARNING:** Do NOT use in an area with strong acid mist.
- **WARNING:** Make sure the installation position can withstand 10 times the weight of the luminaire before installing.
- **WARNING:** Do NOT connect components under load.
- **WARNING:** Do NOT mount the fixture in a manner that can cut or damage the wire insulation.
- **WARNING:** Make sure the fixture has airspace around it. Avoid covering the fixture with anything that could prevent convection or cooling.
- **WARNING:** Only use fixture in its intended location.
- **WARNING:** Do NOT connect and LED fixture to a dimmer pack, occupancy sensor, timing device or other related control devices. Fixtures must be powered directly off a switched circuit.
- **CAUTION RISK OF FIRE:** Do NOT operate near combustible materials or substances affected by heat.

CLEANING & MAINTENANCE:

CAUTION: Be sure the fixture temperature is cool enough to touch. Do NOT clean or maintain while the fixture is energized.

1. Clean refractor/lens with non-abrasive cleaning solution.
2. Do NOT open fixture to clean the LED. Do NOT touch the LED.

Note: These instructions do not cover all details or variation in equipment, nor do they provide for every possible situation during installation, operation or maintenance.

TROUBLESHOOT:

- If the light will not come on:
 - **A.** Light switch is turned off. Turn light switch on.
 - **B.** Fuse is blown, or circuit breaker is turned off. Replace fuse or turn circuit breaker on.
 - **C.** Incorrect circuit wiring. Verify that fixture is wired properly.

LOC-FL-MWMCCT Series Installation Guide

WIRING:

Universal voltage driver permits operation at 120V through 277V, 50/60Hz. For 0-10V dimming, follow the wiring diagram in the drawing.

1. Connect the BLACK fixture lead to the (+) LINE supply lead.
2. Connect the WHITE fixture lead to the (-) COMMON supply lead.
3. Connect the GROUND wire from fixture to supply ground.
 - a. Do NOT connect the GROUND of the dimming fixture to the output.
4. Connect the PURPLE fixture lead to the (V+) DIM lead.
5. Connect the PINK/GRAY fixture lead to the (V-) DIM lead.
6. Cap the YELLOW fixture lead, if present. Do NOT connect.

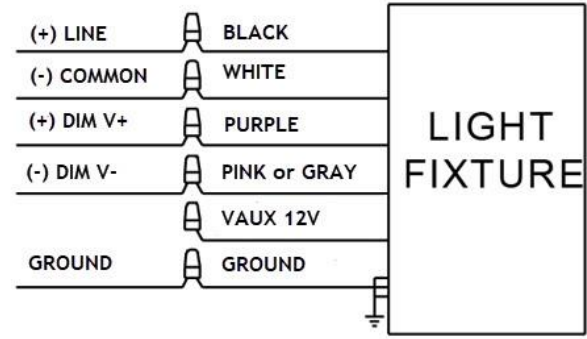

WATTAGE AND CCT ADJUSTABLE TABLE SWITCH SETTING:

1. Locate the area on the side of the fixture with a cap.
2. To unscrew the cap, use a flat head.
3. Select the desired wattage and color temperature.

PHOTOCELL: (located in the same area as the wattage and CCT adjustable switch)

- **ON:** To use the photocell function, make sure the dip switch is selected to ON.
- **OFF:** If the photocell is not needed, make sure the dip switch is selected to OFF.

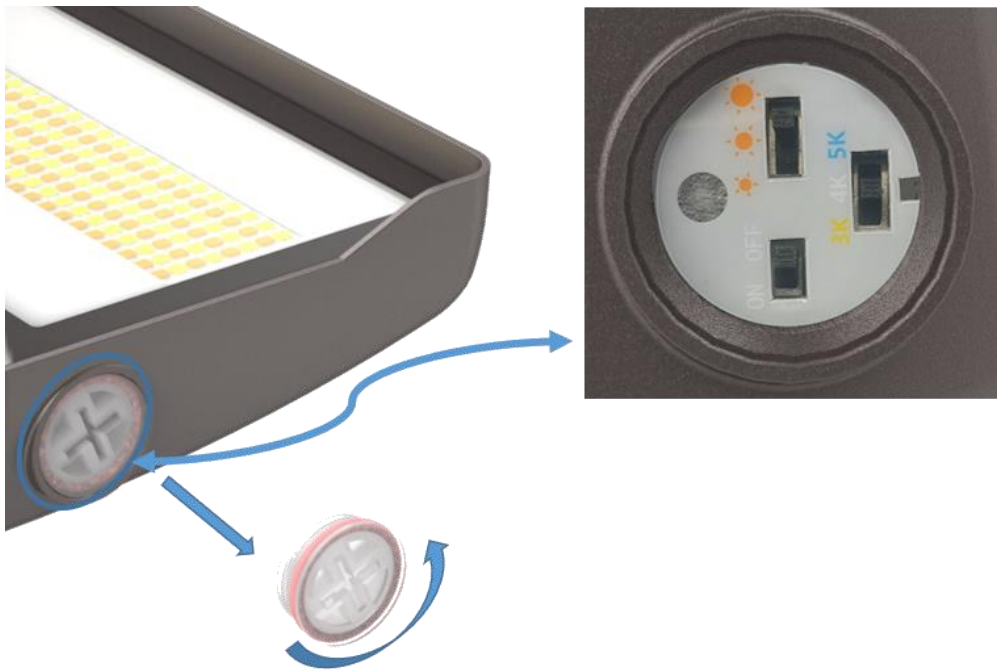

LOC-FL-MWMCCT Series Installation Guide

MOUNTING TYPES:

1. **Knuckle Mounting: (Fig. 1)** (Use for the following models only: 15/25/35 & 35/50/60)
2.
 - a. Thread mounting plate onto knuckle and tighten locknut to secure, or thread knuckle into a ½ NPS hole in a compatible mounting apparatus. Note: Seal arm thread using Teflon tape or silicone sealant. Refer to wiring instructions for power connection.
 - b. Use mounting screws (4) to secure mounting plate to junction box.
 - c. To adjust the tilt angle of the fixture, loosen the ¼-20 socket cap screw in the knuckle with a 3/16 Allen wrench. Rotate that fixture to the desired angle and re-tighten the screw to a minimum 2.2ft-lbs (3Nm) to maximum 2.5ft-lbs (3.5Nm).

Fig. 1

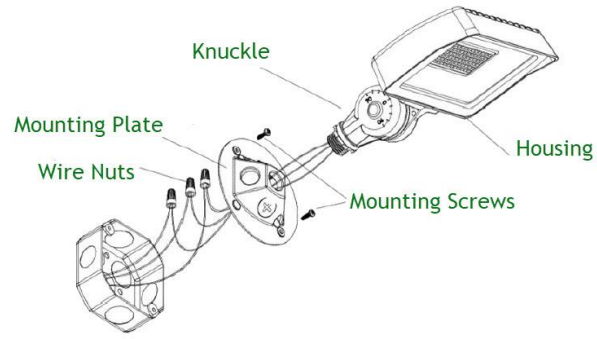

3. **Trunnion Mounting: (Fig. 2)** (Use for the following models only: 15/25/35 & 35/50/60)
 - a. Remove the knuckle mount using an Allen wrench to remove the two ½" ¼-20 socket cap screws. Gently pull the knuckle mount off.
 - b. Thread the cord through the center hole in the upper section of the trunnion.
 - c. Secure the trunnion to the housing with the removed socket cap screws.
 - d. Tighten mount fixture to the desired location with 10#-24 bolts, lock washer and nut (not provided) (minimum 2.2ft-lbs (3Nm) to maximum 2.5ft-lbs (3.5Nm)). See Fig.3 for template.
 - e. To adjust the tilt angle of the fixture, use 3/16" Allen wrench to loosen the ¼-20 socket cap screws on both sides of the trunnion. While holding the fixture in place, use a 9/64" cross screwdriver #8-32 Cross Recessed Pan Head Machine Screws to adjust the desired angle and reinstall the set screw in the appropriate matching hole. Re-tighten screws to minimum 2.2ft-lbs (3Nm) to maximum 2.5ft-lbs (3.5Nm) to secure.

Fig. 2

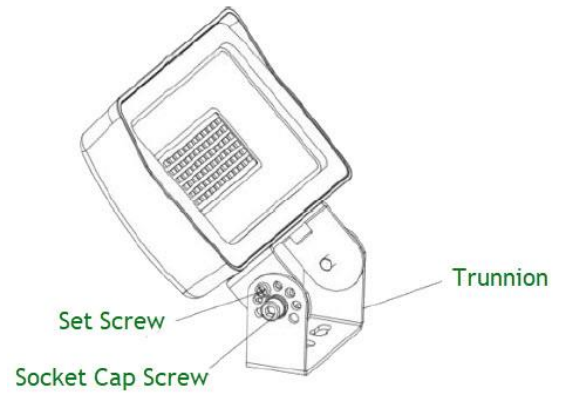

4. **Trunnion Mounting:** (Use for the following models only: 60/80/100, 80/100/150, 100/150/200, 200/240/300 & 240/350/450)
 - a. Thread the cord through the center hole in the upper section of the trunnion.
 - b. Secure the trunnion to the housing with the socket cap screws.
 - c. Tighten mount fixture to the desired location with M8 bolts, lock washer and nut (not provided) (minimum 5.9ft-lbs (8Nm) to maximum 6.4ft-lbs (8.5Nm)). See Fig. 4 for template.
 - d. To adjust the tilt angle of the fixture, use an adjustable Allen wrench to loosen the M8" socket cap screws on both sides of the trunnion. While holding the fixture in place, use a M8 Allen wrench to adjust the desired angle and reinstall the set screw in the appropriate matching hole. Re-tighten screws to minimum 5.9ft-lbs (8.5Nm) to maximum 6.4ft-lbs (8.5Nm) to secure.

Fig. 3

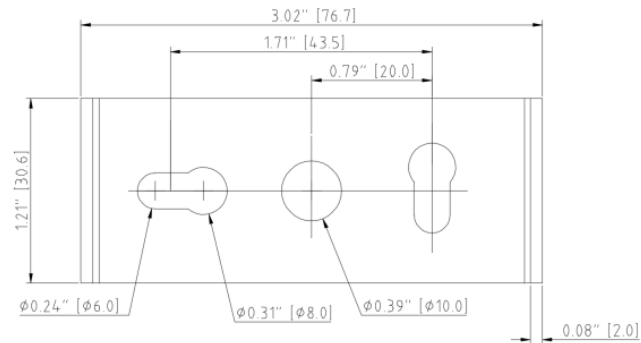
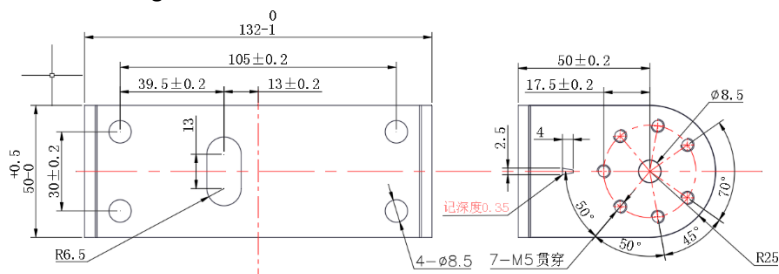

Fig. 4



5. **Knuckle & Stake Mounting: (Fig. 5)** (Use for the following models only: 15/25/35 & 35/50/60)

- a. Thread the stake onto the knuckle and tighten locknut to secure or thread knuckle into a ½ NPS hole in a compatible mounting apparatus. Note: Seal arm thread using Teflon tape or silicone sealant (not provided).
- b. To adjust the tilt angle of the fixture, loosen the ¼-20 socket cap screw in the knuckle with a 3/16 Allen wrench. Rotate the fixture to the desired angle and re-tighten the screw to minimum 2.2ft-lbs (3Nm).

Fig. 5



6. **Slip Fitter Mounting: (Fig. 6)** (Use for the following models only: 60/80/100, 80/100/150, 100/150/200, 200/240/300 & 240/350/450)

- a. Insert the fixture onto the pole and use M8 hex wrench to secure the four M8 screws with a nut into the rotary arm to tighten secure it.

Fig. 6

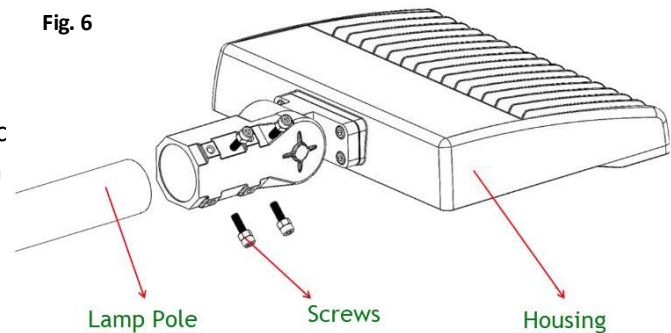

Wire Guard: (Fig. 7)

- When installing the component, connect wire guard to the corresponding holes on the indicator body, and tighten the M4 screw using a cross screwdriver.

Fig. 7

