

300W LED SHOEBOX LIGHT

■ Product Features

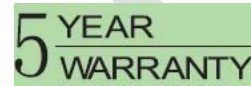

- High efficiency LED Driver, the wide range input voltage AC120-277V or AC277-480V;
- Lumileds LED high luminous efficiency and long life.
- Cast aluminium design, better cooling and easy replacement, light quality, LED Tj < 85°C.
- Excellent optical design, greatly improve the light utilization and evenness.
- Photocell Control Available (Option)



■ Product Applications

WSD LED SHOEBOX Lighting series can be widely used in Urban roads, Industrial areas, Residential areas, Sidewalks, Parking lot, Schools, Gardens and etc.

■ Structure Features

- **Shell materials:** Aluminum & PC.
- **Finish:** Dark Bronze/White
- **Net weight:** 11.50kgs (25.40 lbs)

Unit: inch (mm)

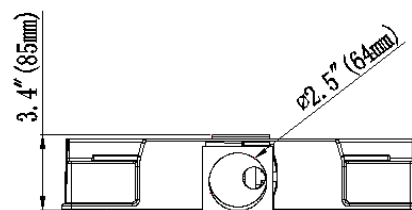
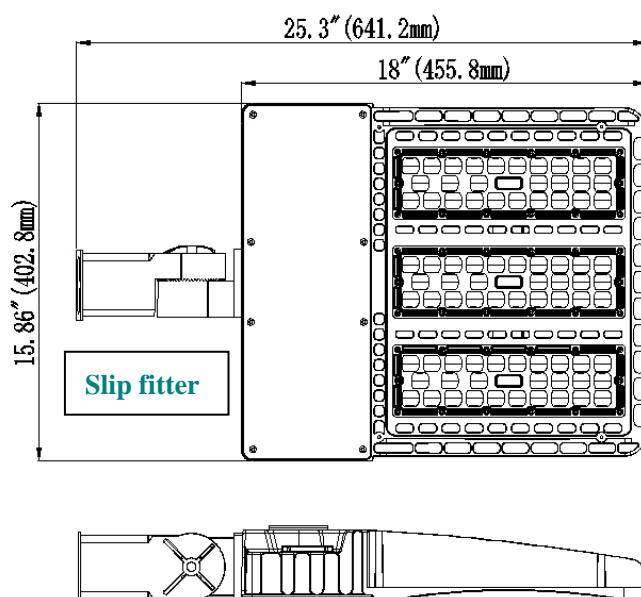

■ Technical Parameters

Type	WSD-SB30W27-XXK-Z-TN-U-Y		
Power	300W	Lighting Angle	Type II, Type III, Type Vs
Input Voltage	AC120-277V/480V	LED Brightness Decay	<5%/6000 hrs
PF	>0.95	Working Life	>50000 hrs
Driver Efficiency	>90%	Working Temperature	-30 - +45°C
Luminous Flux	33600Lm	Storage Temperature	-40 -+80°C
Color Temperature	3000K/4000K/5000K/5700K	Protection Level	Wet Location/IP65
CRI	Ra>80	Cable	3 core, 18AWG

■ Photometry and Type Vs:

LUMINOUS INTENSITY DISTRIBUTION DIAGRAM

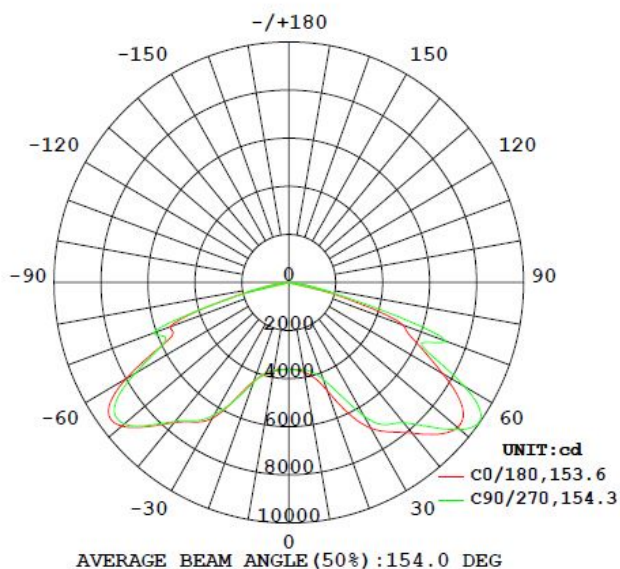

C0 PLANE ISOLUX DIAGRAM (UNIT:lx)

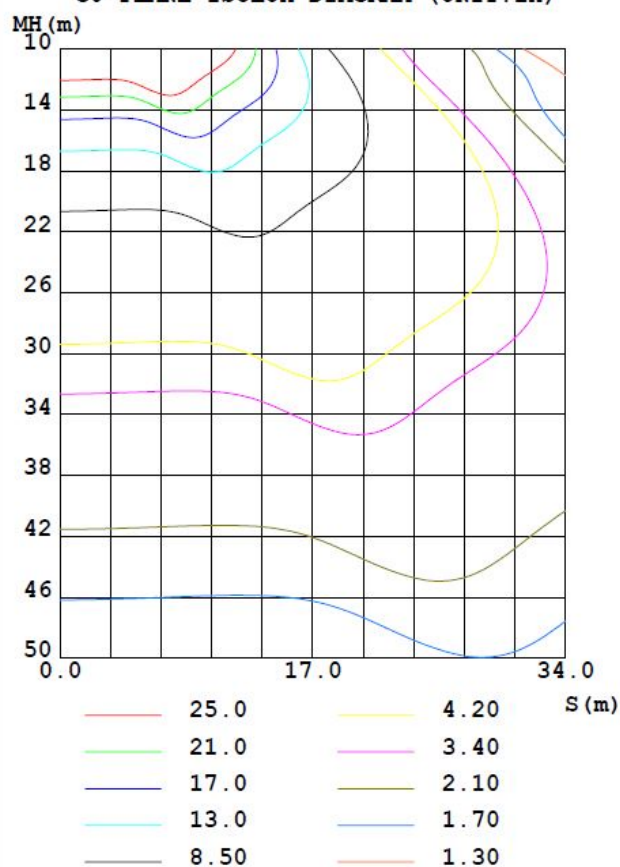

■ Accessory Option:

Arm

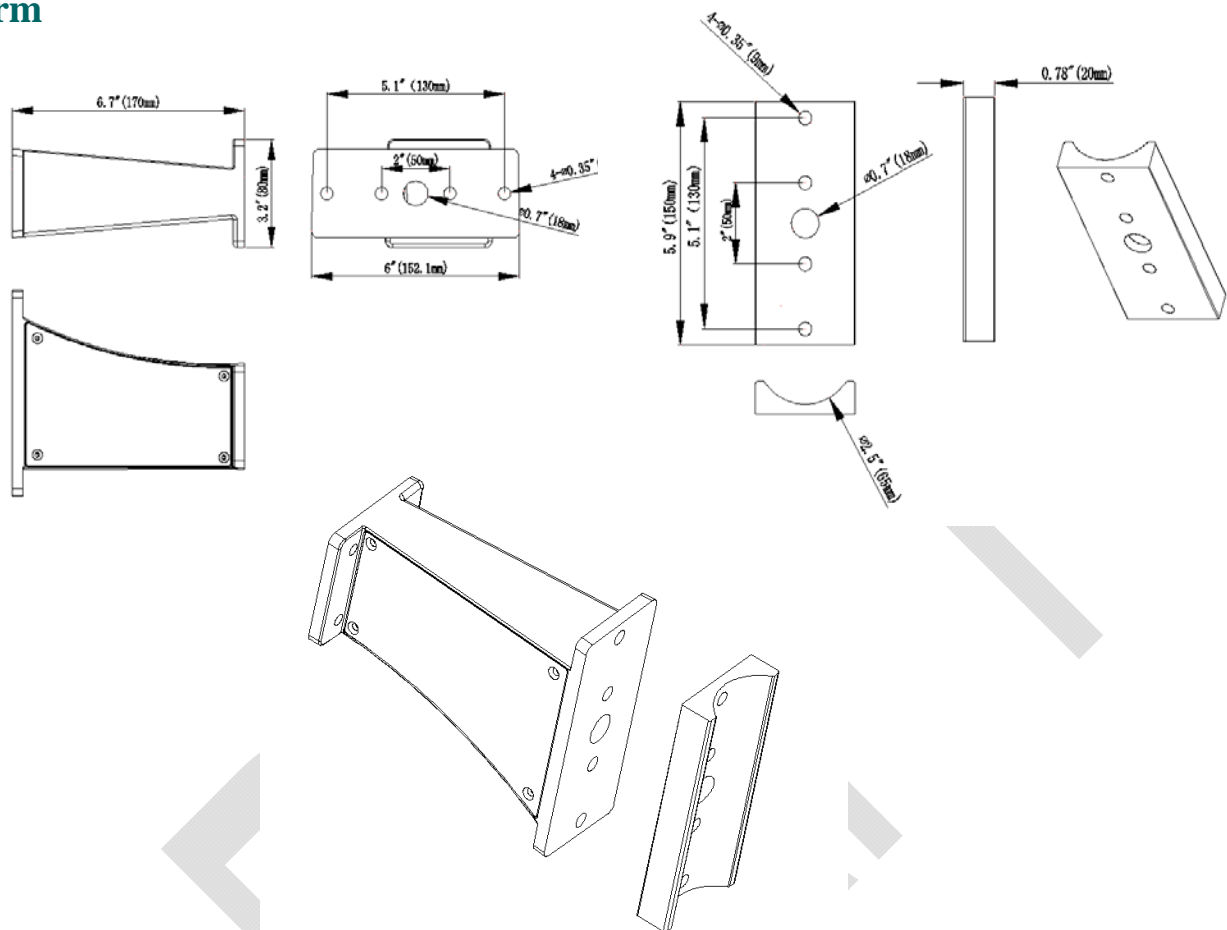

Trunnion

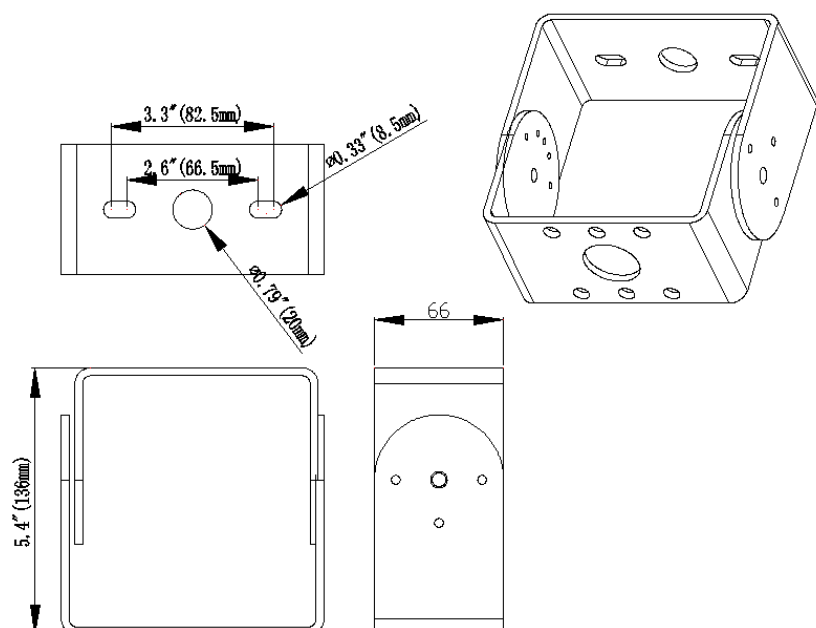

● ORDERING INFORMATION:

EXAMPLE: WSD-SB 30W 27-50K-D-T3-S-P

WSD	SB	20W	27	50K	D	T3	S	P
Company	Product	Power	Voltage	Color Temp	Finish	IES	Mount	Control
WISDOM	SB SHOEBOX LIGHT	06W(60W)	27	30K (3000K)	D	T2	S	P
		10W(100W)	AC120-277V	40K (4000K)	Dark	TypeII	Slip fitter	100-277V
		15W(150W)	48	50K (5000K)	Bronze	T3	T	Photocell
		20W(200W)	AC277-480V	57K (5700K)	W	TypeIII	Trunnion	
		30W(300W)		± 500K	White	T5 TypeV	A Arm	

While “XX” may be any digits represented color temperature;

“Z” may be D or W represented color,

“N” can be 2, 3 or 5 represented type of lighting distribution;

“U” can be S, A or T.

“Y” may be “P12”, “P27” or blank represented type of photoelectric Switches.

■ Product Certifications



■ Contact Us

