

# DJ6T-22-01 6" LED Downlight- Power and Color Switchable



## Indoor

ATG's 6 inch switchable commercial LED downlight can be installed into a hollow opening to create a seamless recessed design. A built in clip allows the downlight to secure snugly within an existing fitting. The fixture is color and power switchable, allowing custom variations, including wattages of 10W, 15W, and 22W and color temperatures of 3000K, 4000K, and 5000K.

Luminaire	DJ6T-22-01 6" Switchable Downlight	Type
Project		
Product		
Notes		



**5**  
Year  
Warranty

Color/Power  
Switchable

Toxin-Free

- ### Features
- Retrofit and new construction installation
  - universal housing compatibility
  - adjustable lumen output and color 3 each
  - 22W/15W/10W
  - 3000K/4000K/5000K
  - Easy fit installation and spring action housing clips
  - universal voltage 110-277 V

selector switch on top of the fixture.

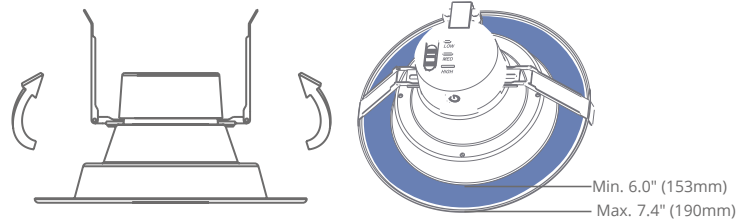

### Application

The customization feature makes this fixture suitable for all applications requiring downlighting. This commercial downlight can be found in applications requiring a cleaner, architectural design. Simply adjust the lamp's power or color to the desired lumen output by sliding the selector switch on top of the fixture.

### Construction

The clips built into the design of this downlight allow the fixture to be adjusted within a range of housings ranging from 6.0"-7.4". The spring clips push easily into this range of both retrofit and new buildings installs.

### Electrical

Product Features		
Wattage (W)	Lumens	CCT
LOW-10W	900	3000 4000 5000
MED-15W	1350	
HIGH-22W	2000	

Current	Wattage (W)	LEDS	LED Current	CRI	Lumens
.08	10W		.05		900
.12	15W	60	.07	90	1350
.18	22W		.11		2000

<b>Input Voltage (VAC)</b>	110-277
<b>CRI</b>	90
<b>CCT(K)</b>	3,000, 4,000, 5,000
<b>Color</b>	White
<b>Housing</b>	Universal housing compatibility
<b>Warranty</b>	5 Years

Selector switch on top of the fixture

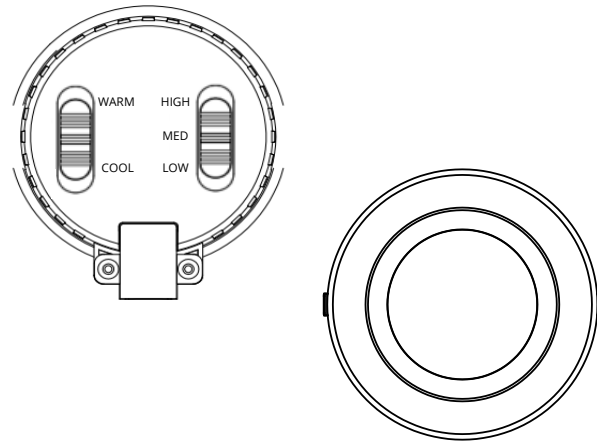

Dimensions	
Depth (D)	Diameter (ø)
3.97	8.22

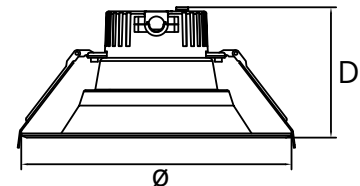

**Installation**

Retrofit Installation

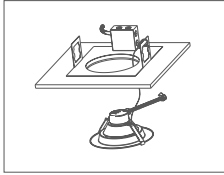

Attach safety clip

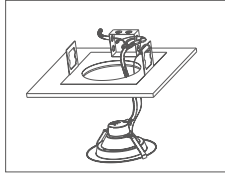

Bypass ballast & wire to j-box

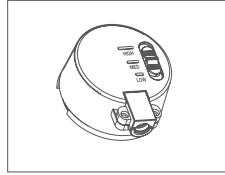

Adjust lumens to desired output

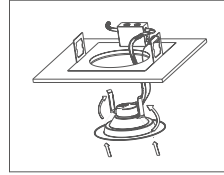

Push clips up & install into fixture

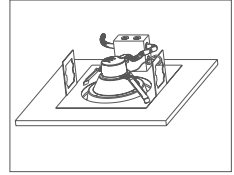

Ensure fixture is flush. Installation is complete

New Construction Installation

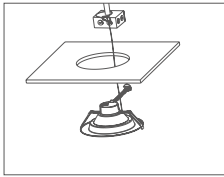

Attach safety clip

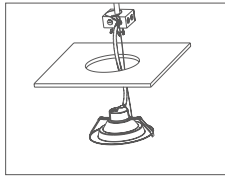

Wire to j-box

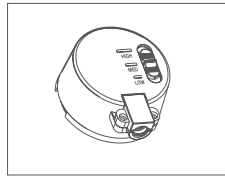

Adjust lumens to desired output

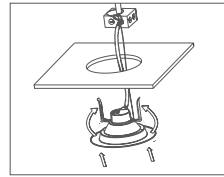

Push clips up & install into opening

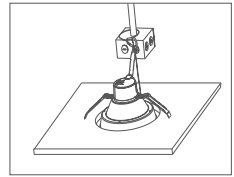

Ensure fixture is flush. Installation is complete