

## CLICK DOWNLIGHT INSTALLATION GUIDE – WARNING

- WARNING** – Read all product labels and instructions before installing fixture.
- WARNING** – Risk of fire or electric shock. LED Retrofit Kit installation requires knowledge of luminaires electrical systems. Installation should be performed only by a qualified electrician in accordance with the National Electrical Code and relevant local code.
- WARNING** – Risk of fire or electric shock. Install this kit only in the luminaires that have the construction features and dimensions shown in the photographs and/or drawings.
- WARNING** – To prevent wiring damage or abrasion, do not expose wiring to edges of sheet metal or other sharp objects.
- WARNING** – Do not make or alter any open holes in an enclosure of wiring or electrical components during kit installation.
- WARNING** – The recessed luminaire is intended for mounting only in a covered ceiling where only the led side of the luminaire will be exposed to wet / damp /dry locations.
- WARNING** – INSTALLATION SHOULD ONLY BE PERFORMED AFTER POWER TO THE FIXTURE HAS BEEN DISCONNECTED.

## 4" J-BOX INSTALLATION

Compatible with most standard 4" J-boxes with minimum height measuring 1.5". Not all existing J-boxes meeting these requirements will be compatible. A test installation should always be performed.

1. Make sure the **POWER IS TURNED OFF** at the source to the J-box in which you are installing the product.
  2. Insert the existing wire ends from the J-box into the LED adapter (fig. 1). Insert the black wire into the side marked (+) and the white wire into the side marked (-). Make sure both wires are tightly secured in the LED adapter.\*
  3. Remove the mounting bracket from the back of the downlight and either cut the attached green ground wire as close to the mounting bracket's ground screw as possible or remove the wire entirely (fig. 2). Loosen the ground screw and wrap the existing ground wire from the J-box around it. Tighten until the ground wire is secure (fig. 3). Discard mounting springs as they are not applicable for J-box installation.
  4. Attach the mounting bracket to the J-box using two of the provided screws (fig. 4). Note the mounting bracket's hooked ends should be facing down once installed.
  5. Connect the end of the LED adapter coming out of the J-box to the downlight (fig. 5).
  6. Push downlight up into the mounting bracket until it clicks into place (fig. 6). Make sure all wires are carefully tucked inside the J-box (fig. 7).
- \*If existing J-box wiring does not allow for the use of the LED adapter, remove the adapter from the downlight and wire directly to the J-box using the provided wire nuts.*

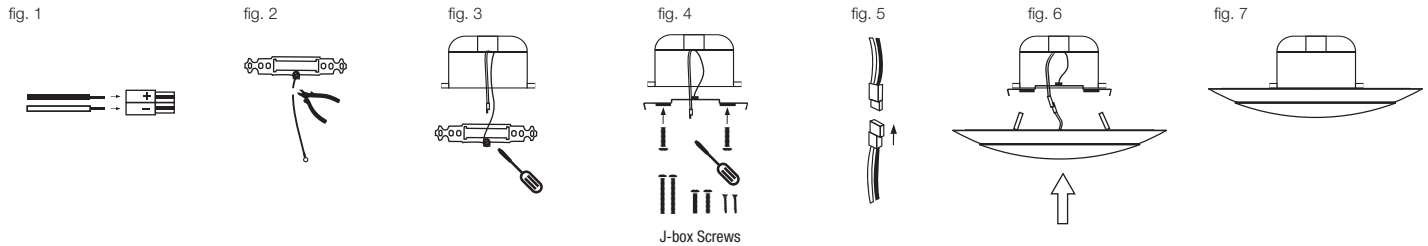

## 5-6" HOUSING COMPATIBILITY

Compatible with most standard 5-6" IC and Non-IC housings that have spring retaining brackets. Compatible with most recessed housing with an aperture measuring 5.00" to 6.20" and minimum height measuring 5.11". Not all existing housing meeting these requirements will be compatible. A test installation should always be performed.

## 4" HOUSING COMPATIBILITY

Compatible with most standard 4" IC and Non-IC housings. Compatible with most recessed housing with an aperture measuring 4" and minimum height measuring 5.05". Not all existing housing meeting these requirements will be compatible. A test installation should always be performed.

## 5-6" RECESSED INCANDESCENT HOUSING INSTALLATION

1. Only for use with accessory SMDL6/ACC (sold separately).
2. Make sure the **POWER IS TURNED OFF** at the source to the recessed housing in which you are installing the product.
3. Insert the wire ends of the E26 adapter into the LED adapter (fig. 1). Insert the black wire into the side marked (+) and the white wire into the side marked (-). Make sure both wires are tightly secured in the LED adapter.
4. Screw the E26 adapter into the socket (fig. 2).
5. Adjust mounting springs on the downlight mounting bracket to match the recessed housing size. If installing in 6" recessed housing, no adjustment is necessary. Downlight comes set up for installation in 6" recessed housing. For 5" recessed housings, move mounting springs to the inner location marked (5) (fig. 3).
6. Connect the end of the E26 adapter to the downlight (fig. 4).
7. Attach the provided green ground wire to inside of the housing using one of the following options (fig. 5): a) Fasten using existing screw inside housing b) Fasten using existing bolt inside housing and provided nut c) Fasten using provided ground screw and existing hole in housing.
8. Insert mounting clips and push downlight up until flush with ceiling
9. Squeeze the mounting springs and insert them inside the housing retaining brackets (fig. 6). Carefully tuck all of the wire inside the housing and gently push the downlight up until flush with ceiling surface (fig. 7).

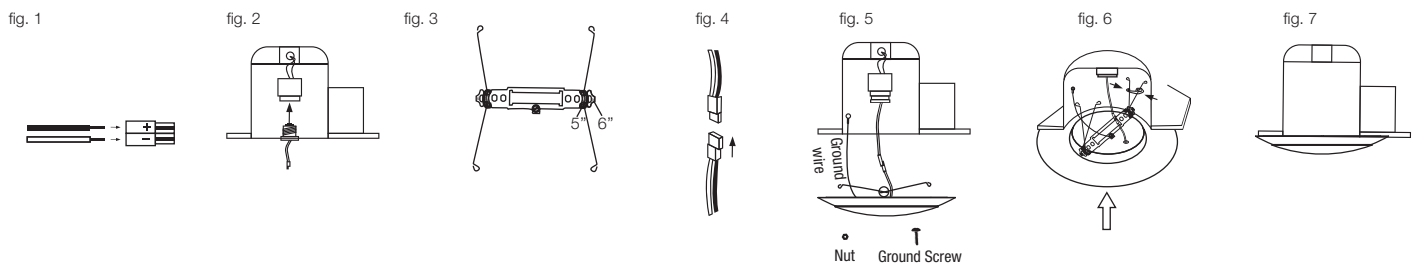

## 5-6" RECESSED LED HOUSING INSTALLATION

Follow installation steps above, omitting Steps 2-3. For Step 5, connect the end of the LED housing adapter to the downlight.

## TITLE 24 INSTALLATION

For installation inside a Title 24 compliant housing with a GU24 line-voltage base, use the GU24 adapter (sold separately). Proceed to Step 3 of **5-6" RECESSED INCANDESCENT HOUSING INSTALLATION** and substitute the E26 adapter with the GU24 adapter.

## 4" RECESSED INCANDESCENT HOUSING INSTALLATION

1. Only for use with accessory SMDL4/ACC (sold separately).
2. Make sure the POWER IS TURNED OFF at the source to the recessed housing in which you are installing the product.
3. Insert the wire ends of the E26 adapter into the LED adapter (fig. 1). Insert the black wire into the side marked (+) and the white wire into the side marked (-). Make sure both wires are tightly secured in the LED adapter.
4. Screw the E26 adapter into the socket (fig. 2).
5. Insert mounting clips into the downlight mounting bracket. (fig. 3).
6. Connect the end of the E26 adapter to the downlight (fig. 4).
7. Attach the provided green ground wire to inside of the housing using one of the following options (fig. 5): a) Fasten using existing screw inside housing b) Fasten using existing bolt inside housing and provided nut c) Fasten using provided ground screw and existing hole in housing.
8. Push downlight up into the housing (fig. 6). Carefully tuck all of the wire inside the housing and gently push the downlight up until flush with ceiling surface (fig. 7).

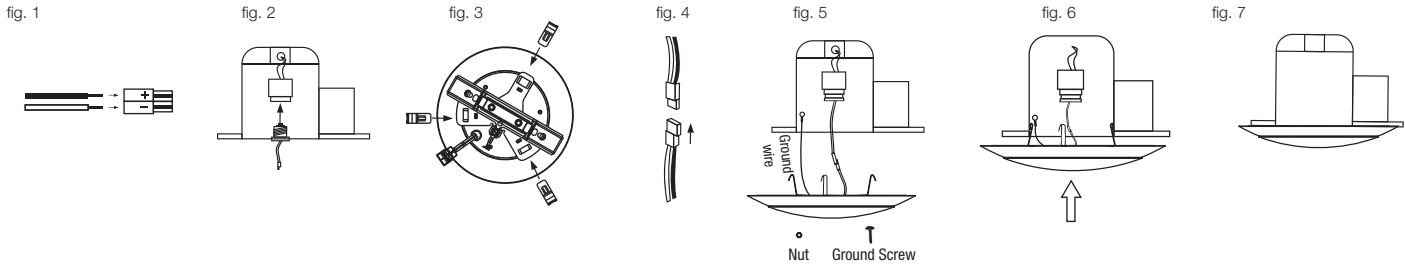

## 4" RECESSED LED HOUSING INSTALLATION

Follow installation steps above, omitting Steps 2-3. For Step 5, connect the end of the LED housing adapter to the downlight.

## TITLE 24 INSTALLATION

For installation inside a Title 24 compliant housing with a GU24 line-voltage base, use the GU24 adapter (sold separately). Proceed to Step 3 of **5-6" RECESSED INCANDESCENT HOUSING INSTALLATION** and substitute the E26 adapter with the GU24 adapter.